

# The Thomasville

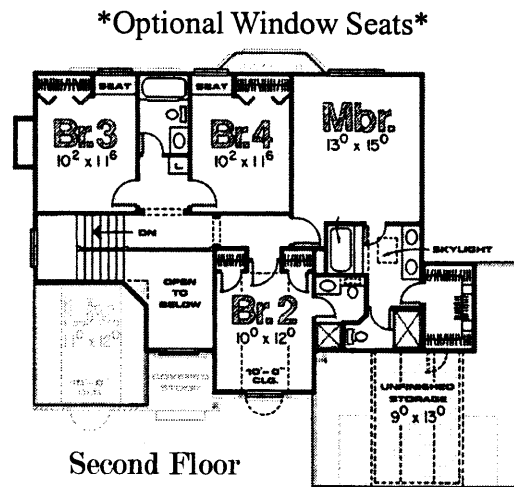
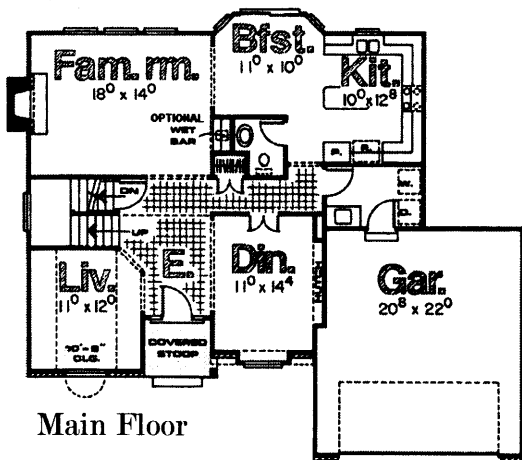

\*Bedroom 2 Bath is Optional\*

Main Floor	1179 sq ft
Second Floor	1019 sq ft
<b>Total</b>	<b>2198 sq ft</b>

Modern Homes, Inc. 25165 Runyard Way West. Trevor, WI 53179  
 (262) 862-6000 www.modern-homes.com

Plans are conceptual. Please see your salesman for exact layout.